



## 27 Lingfield Road

, London, SW19 4PU

£1,195,000

This superb three-bedroom period ground floor flat is beautifully presented throughout and located on one of the most prestigious roads in Wimbledon Village.

- Three bedrooms
- Ground floor flat
- Separate study
- Large reception room
- Eat-in kitchen
- Two bathroom (one en-suite)
- Central location in Wimbledon Village
- Off-street parking
- Share of freehold
- West facing private patio and communal garden

### Viewing

Please contact our Hume Homes Office on 07714 659 220 if you wish to arrange a viewing appointment for this property or require further information.



Floor Plan

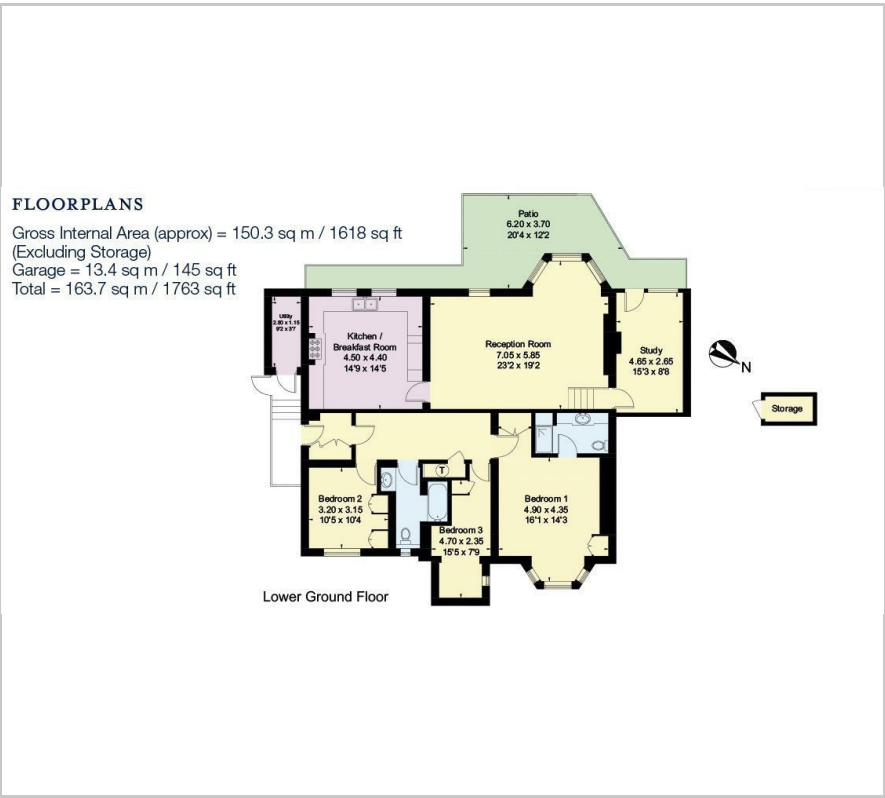

Area Map



Energy Efficiency Graph

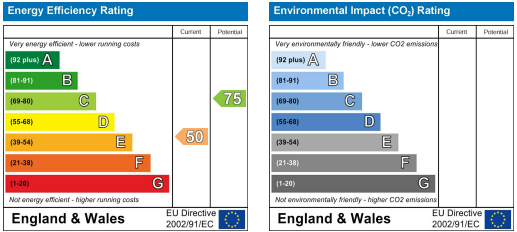

These particulars, whilst believed to be accurate are set out as a general outline only for guidance and do not constitute any part of an offer or contract. Intending purchasers should not rely on them as statements of representation of fact, but must satisfy themselves by inspection or otherwise as to their accuracy. No person in this firm's employment has the authority to make or give any representation or warranty in respect of the property.